



# RAMAKRISHNA MATH

(A Branch Centre of Ramakrishna Math, Belur Math, Howrah, West Bengal)

**BHATTA BAZAR, PURNEA, BIHAR-854301**

Phone : +91 9588986194 / +91 6454359035

Website : <https://purnea.rkmm.org>

E-mail : [purnea@rkmm.org](mailto:purnea@rkmm.org)

# APPEAL

Dear Friends and devotees,

It is a matter of great fortune that by the will of Sri Bhagavan and all of you a branch center of Ramakrishna Math, Belur has been started at Purnea Town in Bihar recently. As you know very well that The Life and Teachings of Bhagavan Sri Ramakrishna, Holy Mother Sarada Devi and Swami Vivekanandaji are full of with the potential to establish and upkeep the world-peace and brotherhood among the nations. And if followed, can lead one to God realization or Self-realization also. Swami Vivekananda has started Ramakrishna Math and Ramakrishna Mission as the two effective laboratories to achieve these goals.

The essential building structures at Ramakrishna Math, Purnea have been designed with the consultation of learned men, thinkers and devotees which will provide the Math to run its humanitarian activities at ease in this North -East Bihar region as wish fulfilling tree.

**We appeal to one and all to come forward to imprint your name and a part of your earned wealth which you have acquired by hard labour, in the History of the Purnea Town by donating that for this noble cause of Swami Vivekanandaji Maharaj to serve the humanity and be blessed.**

Yours in the service of Bhagavan Sri Ramakrishna in all

**Swami Jitendrananda**  
Adhyaksha  
Ramakrishna Math, Purnea

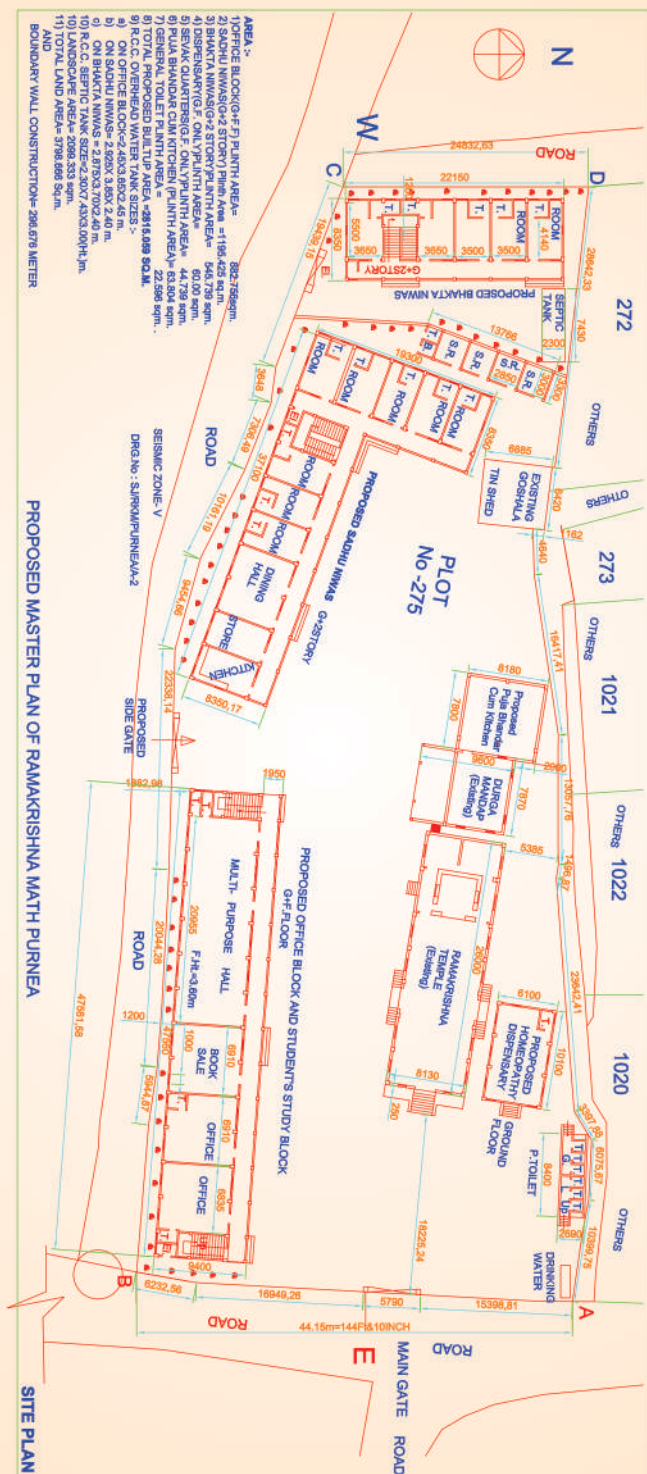





(Long View)



(Closeup View)

## Sadhu Niwas

Since the Math campus is not so big, therefore to facilitate most of the service activities accommodation, a Master Plan of the whole campus has been prepared. It has four parts:

1) **Bhakta Niwas** - It will be in 3 Story with total plinth area 545.739 sqm and estimated cost ₹ 2.19 crores. The volunteers from the country and abroad who will help the Math in its various service activities and devotees will be accommodated here.

2) **Office and Student Study Block** - It will be in 2 Story with total plinth area 882.756 sqm and estimated cost ₹ 4.07 crores. On the ground floor, there will be office, book sale, and multi-purpose Hall and on the upper floor, there will be student's self-study rooms with all facilities.

3) **Sadhu Niwas** - It will be in 3 Story with total plinth area 1195.425 sqm and estimated cost ₹ 4.76 crores. To run the Math service activities, the whole-time dedicated Sannyasi-Brahmacharins and Sadhu guest will be accommodated here.

4) **Puja Bhandar, Sevak Quarters, Dispensary and Public Toilet** - These will be in one story with total plinth area 191.17 sqm and estimated cost ₹ 77.29 lakhs. To run the Math service activities effectively, these have to be rebuilt by replacing old ones.

Keeping in view the need and ease of work, we have planned to take up the work in the above sequence.

- The donations given to Ramakrishna Math, Purnea are exempt from income tax under section 80G (5) (vi) of Govt. of India.
- Any donation for our any service work however small or big will be thankfully accepted and acknowledged and their receipt will be served.
- DD/Cheque/M.O. can be made in the favour of "RAMAKRISHNA MATH, PURNEA" and can be sent to "Adhyaksha, Ramakrishna Math, Purnea, P.O. Bhatta Bazar, Purnea, Bihar - 854301.". Please do give your name with full postal address and **PAN No. or AADHAAR No.** And for further interaction please give your email and mobile number also.
- The name of the kind donors from ₹ 1 lakh to ₹ 10 lakh will be written on granite stones collectively on the structures and above that amount will be written on independent granite stone on the structures.
- You can help us by introducing donors and donating companies or donating establishments with us. And you can also help us to circulate this appeal to as many people you can by your electronic gadgets.
- Please contact us for further details on -  
Mobile No. : 09588986194, 09264994058, 06454359035  
E-mail : [purnea@rkmm.org](mailto:purnea@rkmm.org)  
Website : <https://purnea.rkmm.org>

**Devotees and well-wishers can donate us in the following account heads to participate in our holy service activities :-**

- 1) Daily Worship and God Service (in religious festivals)
- 2) Basanti Durga Puja
- 3) Sadhu Seva (Bhakta Seva is included)
- 4) Building Construction and Repair
- 5) General fund (It can be utilized in all work)
- 6) Homeopathy Dispensary
- 7) Go-seva
- 8) Youth Orientation (all work to elevate Youth can be included).

RAMAKRISHNA MATH, PURNEA  
PNB(MATH)/C 0051010238472  
IFSC CODE: PUNB0005120

### **Activities :-**

- Daily worship of Bhagavan Sri Ramakrishna
- Special Puja, Bhajan and cultural programs on the Tithi Puja (birth day acc. to Vishuddha Siddhanta almanac) of Bhagavan Sri Ramakrishna, Holy Mother Sarada Devi and Swami Vivekananda
- Basanti Durga Puja, Guru Poornima, Shiva Ratri etc. celebrations are observed
- Homeopathy Dispensary
- Lecture and Discourses on Shastra and life and teaching of Bhagavan Sri Ramakrishna, Holy Mother Sarada Devi, Swami Vivekananda and the direct disciples of Sri Ramakrishna
- Relief work when needed.

### **Proposed Building View**



### **Bhakta Niwas**

